

STANDARD DUTY AUGER REPAIR PARTS

HEAVY DUTY AUGER REPAIR PARTS

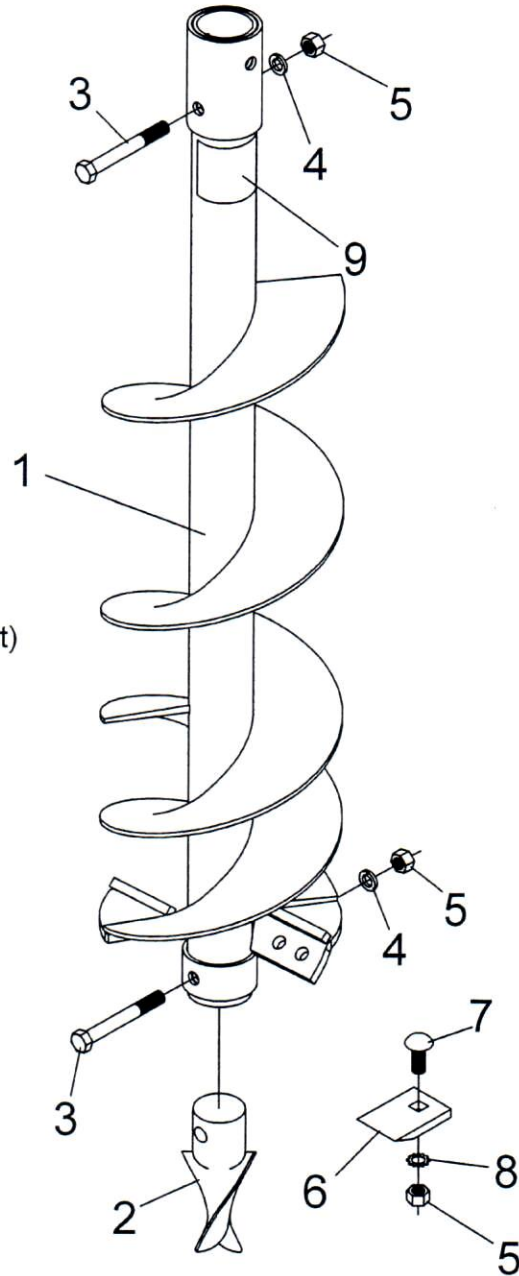
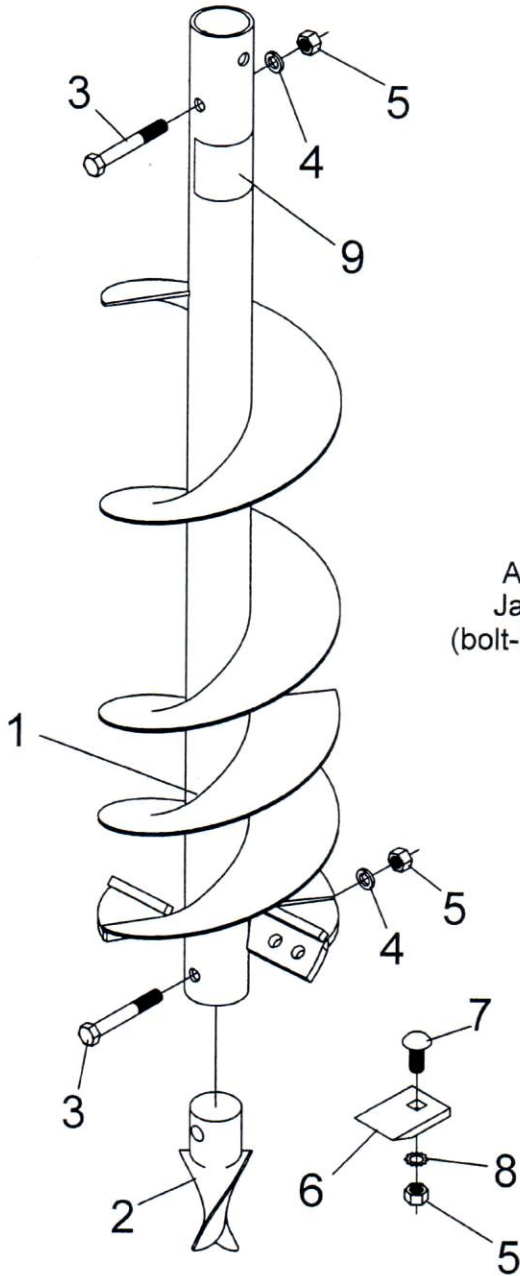

Augers after
January 2010
(bolt-in center point)

| Ref. No. | Part No. | Description | No. Req'd. |
|----------|----------|---|------------|
| 1 | 170585 | 6" Dia. Standard Duty Auger (Complete) | 1 |
| | 170710 | 9" Dia. Standard Duty Auger (Complete) | 1 |
| | 170720 | 12" Dia. Standard Duty Auger (Complete) | 1 |
| 2 | 170430 | Fishtail Auger Point (Bolt-In) | 1 |
| 3 | 2503012 | Bolt 1/2"-13NC x 3" Hex Head Gr. 2 | 3 |
| 4 | 2502002 | Washer 1/2" Springlock | 3 |
| 5 | 2500003 | Nut 1/2"-13NC Full Hex | Var. |
| 6 | 706021 | Red Claw Digger Tooth | Var. |
| 7 | 2503166 | Bolt 1/2"-13NC x 1 1/4" Carriage Head Gr. 2 | Var. |
| 8 | 2502003 | 1/2" External Star Lockwasher | Var. |
| 9 | 101131 | Safety Sign - Danger (Guard Missing) | 1 |

| Ref. No. | Part No. | Description | No. Req'd. |
|----------|----------|---|------------|
| 1 | 706150 | 6" Dia. HD Single Flight Auger (Complete) | 1 |
| | 706109 | 9" Dia. HD Single Flight Auger (Complete) | 1 |
| | 706112 | 12" Dia. HD Single Flight Auger (Complete) | 1 |
| 2 | 170430 | Fishtail Auger Point (Bolt-In) | 1 |
| 3 | 2503109 | Bolt 1/2"-13NC x 3 1/2" Hex Head Gr. 2 | 3 |
| 4 | 2502002 | Washer 1/2" Springlock | 3 |
| 5 | 2500003 | Nut 1/2"-13NC Full Hex | Var. |
| 6 | 706021 | Red Claw Digger Tooth | Var. |
| 7 | 2503166 | Bolt 1/2"-13NC x 1 1/4" Carriage Head Gr. 2 | Var. |
| 8 | 2502003 | 1/2" External Star Lockwasher | Var. |
| 9 | 101131 | Safety Sign - Danger (Guard Missing) | 1 |